

Approx Gross Internal Area
41 sq m / 442 sq ft

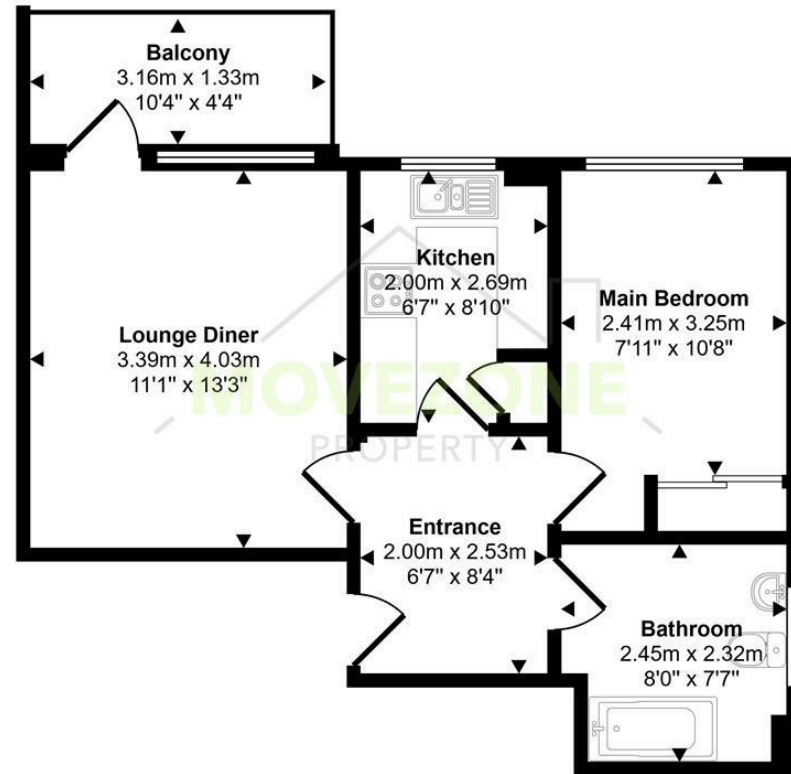

Floorplan

This floorplan is only for illustrative purposes and is not to scale. Measurements of rooms, doors, windows, and any items are approximate and no responsibility is taken for any error, omission or mis-statement. Icons of items such as bathroom suites are representations only and may not look like the real items. Made with Made Snappy 360.

Directions

Contact

223 Southborough Lane
Bromley
Kent
BR2 8AT

E: info@movezone.co.uk

T: 0208 3139075

<https://www.movezone.co.uk>



**1 Bed
Flat
located in**



Flat 2, 35, Howard Court Bromley Road

£1,375 PCM



An excellent opportunity to rent this well presented one bedroom ground floor flat with private balcony and garage, ideally located on Bromley Road, Beckenham. Recently updated with new flooring throughout (excluding the bathroom), the property offers bright and comfortable living in a highly convenient location.

The accommodation comprises a spacious lounge with direct access to a private balcony, a well proportioned double bedroom, a fitted kitchen, and a bathroom. The flat benefits from gas central heating, off street residents' parking, and a private garage, providing excellent additional storage or secure parking.

Set within well maintained communal gardens, the property offers a pleasant residential setting while remaining close to local shops, amenities and transport links. Just a short walk to Beckenham Town Centre, and 15 minute walk to Beckenham Junction Station.

Contingency deposit is £1,586.00

EPC Rating: C

Council Tax Band: B

Don't miss the opportunity to call this beautiful flat your new home!

